

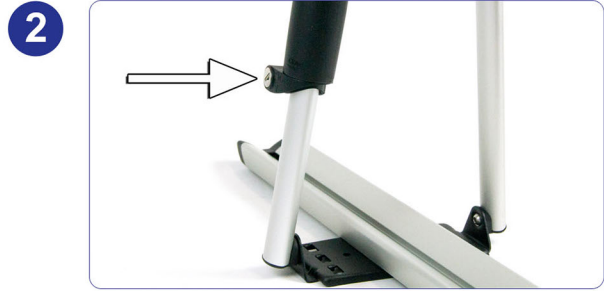

Atera GIRO AF - A-frame lock removal and refit



1 Place the carrier on a flat surface.



2 Lift the A-frame up into the vertical position and identify the lock on the ratchet handle.



3 On the opposite side of the lock housing there is a circular rubber stopper that covers the lock barrel.



4 Using a thin flat head screwdriver, push in between the side of the rubber stopper and the lock housing.



5 Once inserted to roughly 5mm, push against the lock housing in order to lever the rubber stopper out.

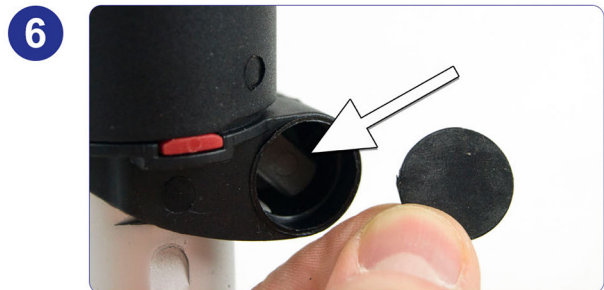

6 Remove the stopper by hand and keep safe. You can now see the end of the lock barrel.



7 Insert the keys.



8 * View of the lock barrel in the locked position.*





Turn the key to the unlock position.



* View of lock barrel in unlocked position.*



Now identify the retaining lock barrel tooth.



Insert a very thin flat head screwdriver into the lock housing and push the retaining tooth into the lock barrel.



Keeping the tooth pushed in, use a finger or thumb on the other hand to push the lock barrel half way out of the housing (until the retaining tooth is free).



Remove the screwdriver and with the other hand remove the lock barrel (turning the barrel from left to right when removing will help).



Now take the replacement lock barrel and insert the key.



Insert the lock barrel and key at a rough 45-degree angle (locked position).



17

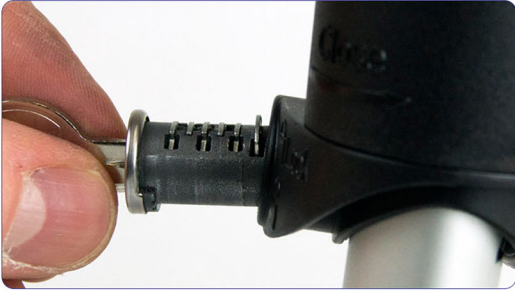

As you can see the retaining tooth is the only prominent tooth.

18

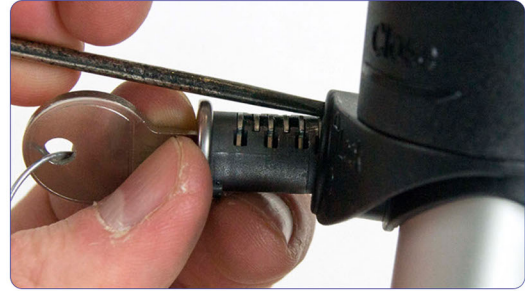

Using the same thin flat head screwdriver, push the retaining tooth into the lock barrel (approx. 5mm) whilst pushing the lock into the housing.

19



Remove the screwdriver and push the remainder of the barrel into the housing. You should be able to see the retaining tooth in position from the other side.

20



Push and turn the lock into the unlocked position and insert the rubber stopper into the lock housing.

21



Gently push with your thumb until the stopper is in place.

22



The carrier is now ready to use.