



## Atera STRADA EVO/VARIO - how to fit the number plate



1 We recommend fitting your number plate before fitting to the carrier to your vehicle and attaching your bikes.



2 There are four metal clips on the back side of the number plate.



3 Lift each one of these clips up 90 degrees.



4 You should hear a click and the clip will become loose. This will now allow access to a plastic retaining clip.



5 Slot your number plate into the plastic number plate strip (AR092967). Notice there are four open slots spaced along the number plate strip.



6 Insert both the number plate strip and number plate into the plastic housing at a 45 degree angle. Make sure both plastic catches are visible.



7 To fix the number plate into the housing you will need to pull up on each of the four retaining clips whilst pushing the number plate holder into place.



8 Start from one side and work your way across. You should hear a click as each point engages.



This leaflet has been produced by John Jordan Limited and is intended to supplement the manufacturer's instructions supplied. Please always follow the manufacturer's instructions. This advice is offered on the understanding that John Jordan Limited will not accept responsibility for any errors or omissions, or for any damage or injury incurred by choosing to follow any additional advice contained in this leaflet. Please always follow the manufacturer's instructions!

© These pictures and words are the copyright of John Jordan Limited trading as The Roof Box Company, all rights reserved.

help@roofbox.co.uk  
01539 621884



CLICK!



CLICK!



CLICK!

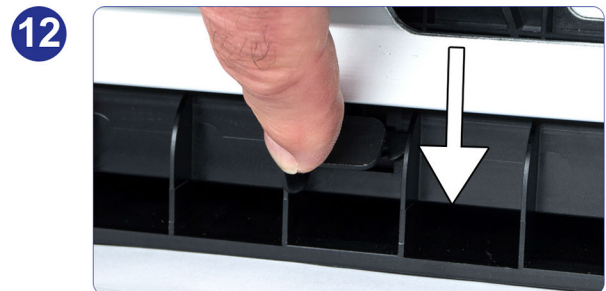

Once the number plate has been clicked into place, you will then need to lock it in place.



Push all four clips on the back side of the number plate down 90 degrees.



Once in place each clip should sit flush against the plastic housing and cover the retaining clip.



Your number plate is now ready to use.



If you need to remove your number plate for whatever reason, simply reverse the process.